

Bournbrook

Technical File

T1.16I



Wall Mounted 2 Hole Basin Mixer Rough Parts

Technical Drawing

Measurements in "mm."

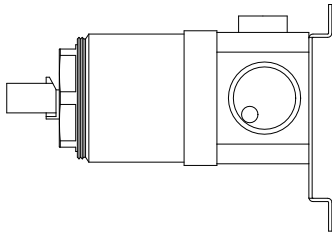

Side View

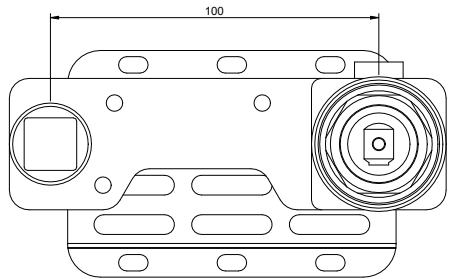

Front view

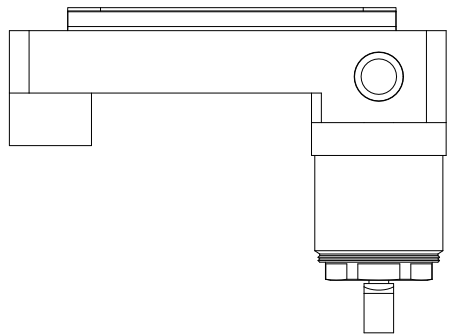

Top View

TECHNICAL DATA

Minimum Pressure	1 BAR
Maximum Pressure	10 BAR
Recommended Working Pressure	2-5 BAR
Maximum Water Temperature	70° / 176 F
Maximum Water Temperature Recommended	65° / 149 F
Flow Rate with Aerator	5.6 l/min - 3 Bar

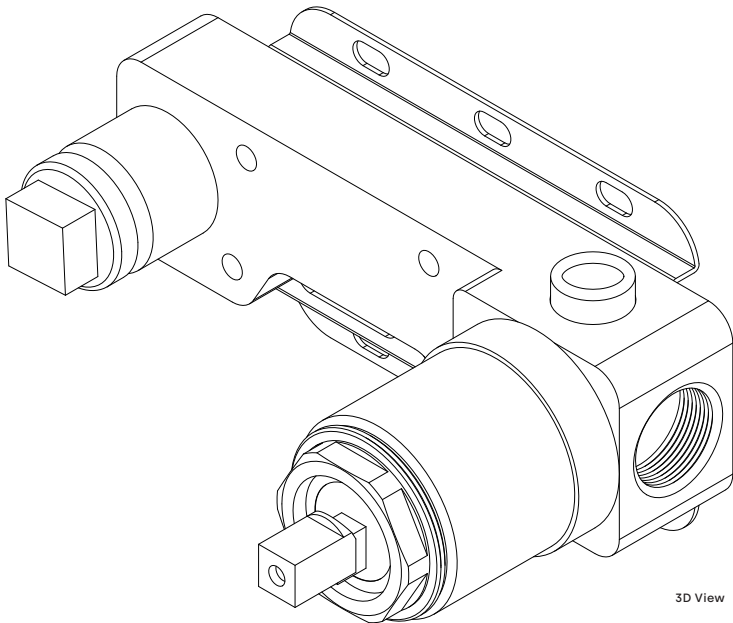

3D View

Component Drawing

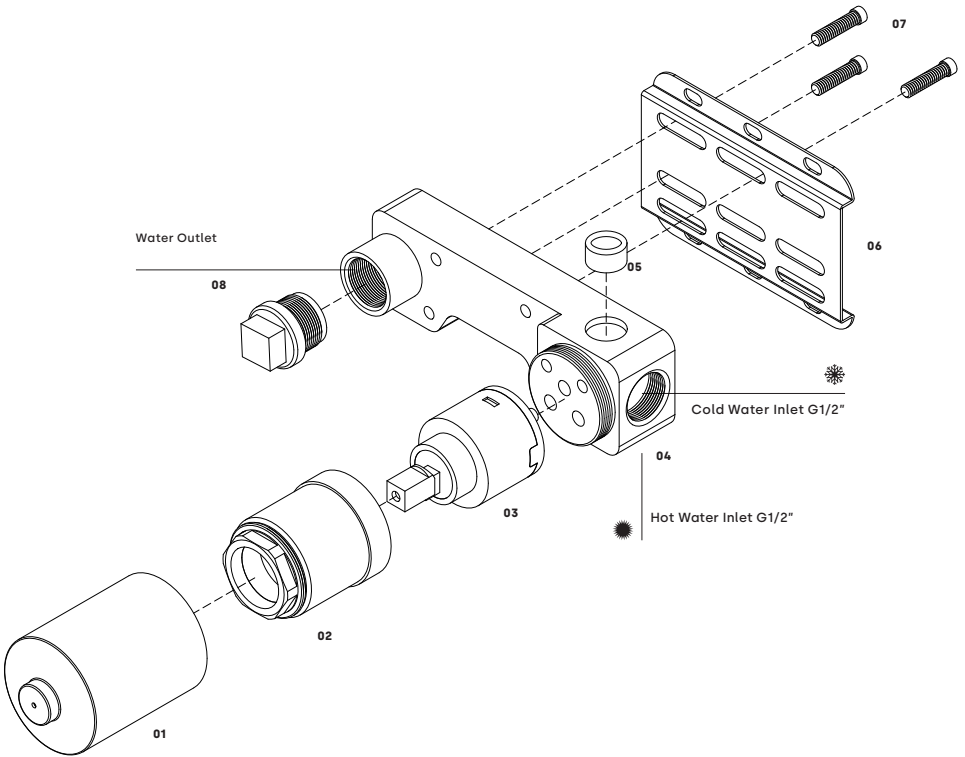

COMPONENT LIST

01 Plastic Cup

02 Tecaform Fastening Nut

P38629

03 35 mm Cartridge

P26377

04 Monoblock

05 Spirit Level

06 Fixing Plate

07 Screw

08 Half Inch Cap T

COMPATIBLE WITH

T1.16BE.SB



T1.161BE.SB

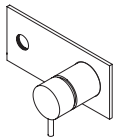

T1.675

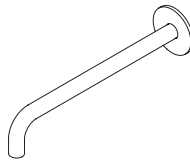

T1.675.SE

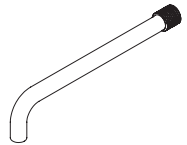

Assembly Instructions

PICTURE 01

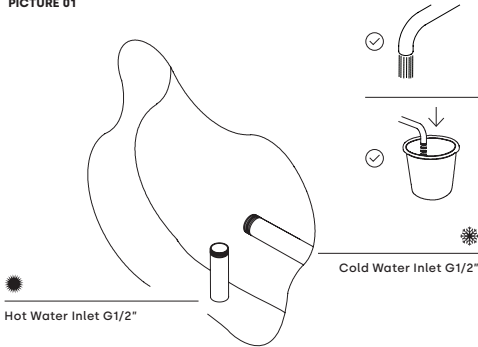

Attention!

Before starting the installation, the pipes must be properly cleaned to eliminate any dirt that may cause permanent damages to the cartridge.

PICTURE 02

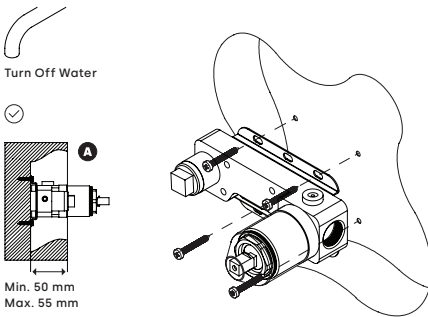

Ensure the water supply is turned off before proceeding to the mixer installation.

- 01 Verify on the picture "A" the maximum and minimum measurements for internal part installation.
Min. 50 mm / Max. 55 mm
- 02 Please mark the wall where the internal part T1.161 will be placed.
- 03 After marking four fixation points, drill the wall.
- 04 Screw the fixing plate with compatible bolts (not included), leaving them untight enough for the following step.

PICTURE 03

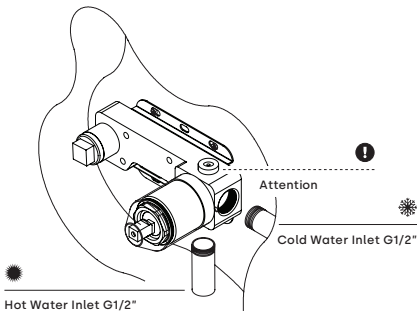

- 01 Confirm on the spirit level (included on the mixer seat) that the piece is levelled with the floor (☉). After ensuring the alignment is correct, conclude the tightening of the bolts.
- 02 Proceed to the water connections, connecting cold and hot water to the corresponding tubes.
- 03 Please guarantee that these connections are done correctly before placing the coating on the wall.

PICTURE 04

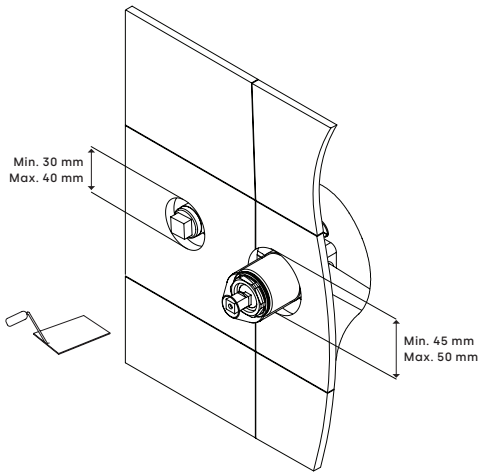

01 Drill the holes on the coating, for the mixer and spout.

Mixer diameter:
Min. 45 mm / Max. 50 mm
Spout diameter:
Min. 30 mm | Max. 40 mm

02 After completing step 1, proceed with the application of the coating.

Cartridge Replacement

01



02

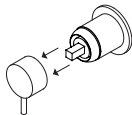

01 Unscrew the handle with the help of the allen key.

02 Remove the handle from the top of the cartridge.

03

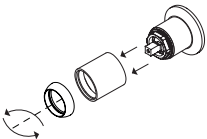

04

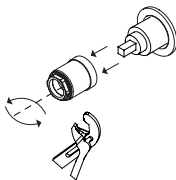

03 Unscrew the cartridge concealer from the tecaform locknut, then remove the hood from the tecaform piece.

04 Unscrew the tecaform locknut with the help of a wrench. After this, you can remove the cartridge.

To apply a new cartridge, please consider the reverse procedure.

RECOMMENDATIONS

The installation must be made by specialized technicians that have to consider the instructions contained on the product.

The components of the product cannot be altered or modified, otherwise the warranty will be annulled. The recommended pressure and temperature must be strictly followed. If they are exceeded or reduced, it can cause permanent damages to the tap.

MAINTENANCE

We recommend regular maintenance of the tap in order to assure the permanent good function of it.

To clean the tap, please use a smooth cloth with water and neutral soap. Never use products with abrasives substances such as chloride acid, ammonia, acetone, vinegar, bleach or abrasive sponges.

The usage of non-recommended products might damage permanently the surfaces which will annul the warranty.

WARRANTY

Waterrevolution guarantees all its products in case of manufacturing defects, as follows:

5 Year warranty :

- Machining or casting faults and porosity defects;
- Cartridge and valve defects (the wear of this component depends on water quality);
- Chrome plating or PVD defects. Defects caused by improper use are excluded, please refer to the maintenance instructions.

2 Year warranty :

- Powder Coating finishes. Defects caused by improper use are excluded, please refer to the maintenance instructions.
Our responsibility is exclusively subject to defects originated on the production process.

The warranty does not cover components subject to wear and tear, such as O-rings, gaskets, flexible hoses and joints for connections.

Attention :

Natural finishes, such as brass or stainless steel, depend entirely on the exposure to the environment and maintenance. Therefore, any stain that may appear cannot be considered a product defect.

The warranty gives the customer the right to have all the parts replaced, free of charge, if they are not working properly, due to manufacturing fault.

The following are excluded from the warranty:

- Items or parts which are damaged or do not work properly due to negligence in the use or wrong maintenance;
- Wrong installation;
- Intervention by unqualified people or circumstances beyond one's control.

In order to use this warranty, please keep the invoice and attach it to this document. Defective products must be sent to Claybrook Studio with shipping expenses borne by the sender. This warranty document and a copy of the purchase invoice must be attached to the package. The products will be promptly replaced and sent back with shipping expenses borne by Claybrook Studio.
