



Claybrook.

PRODUCT DATA SHEET

SHO-BRO-CON-3OT (VCS606-T...) Trim set for 3 outlet thermostatic valve



- Available Control Options -



CHML



PNBL



Claybrook.

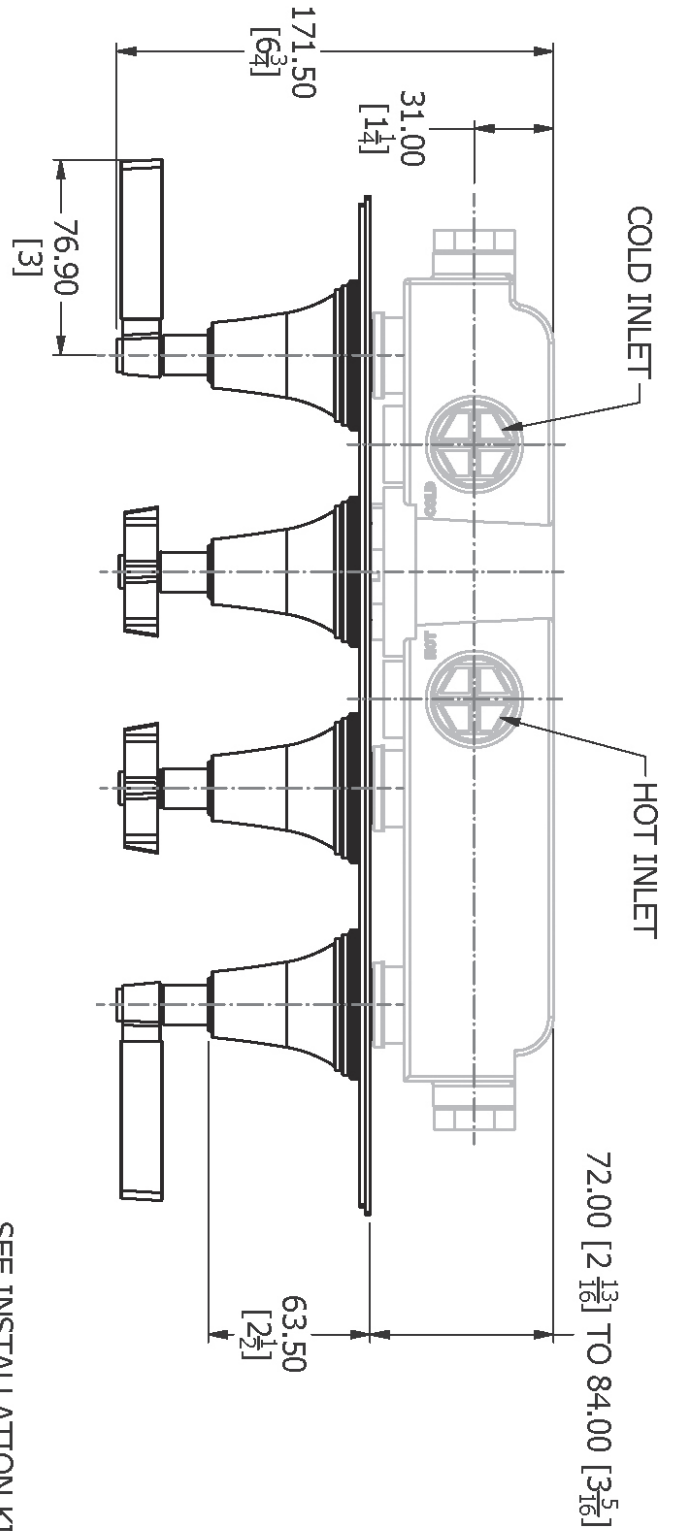
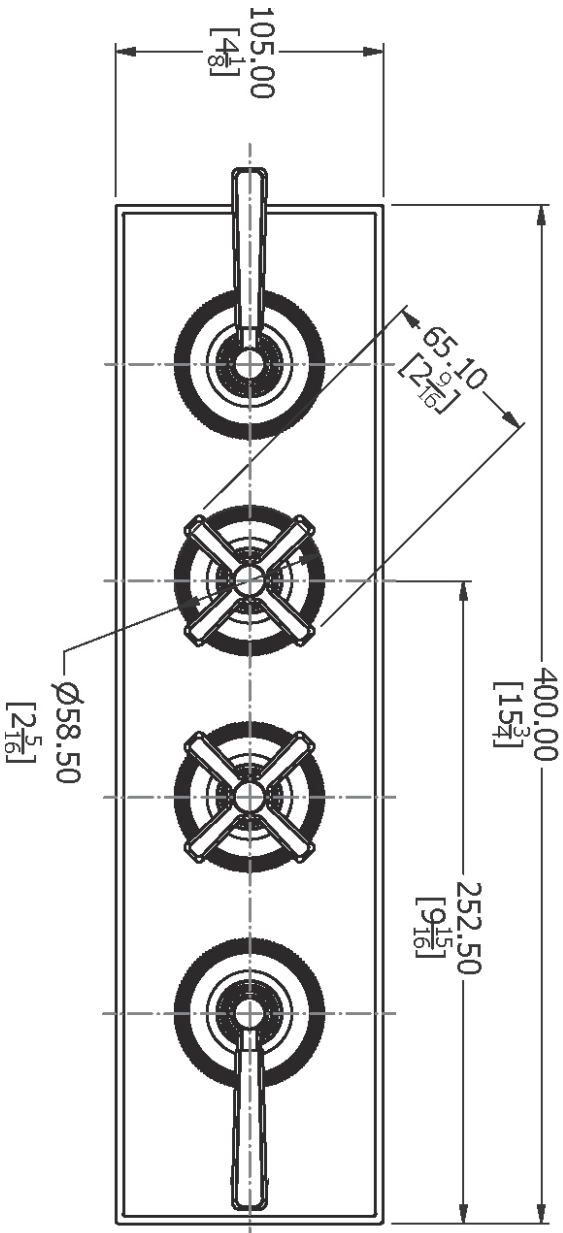

SEE INSTALLATION KIT DRAWING
VCS606-IS

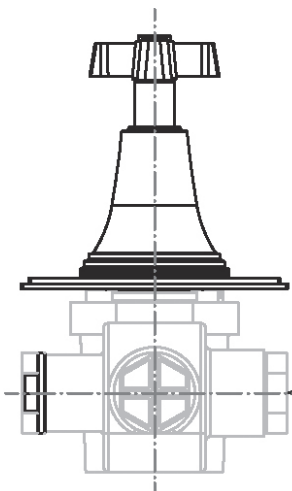

Spares Information

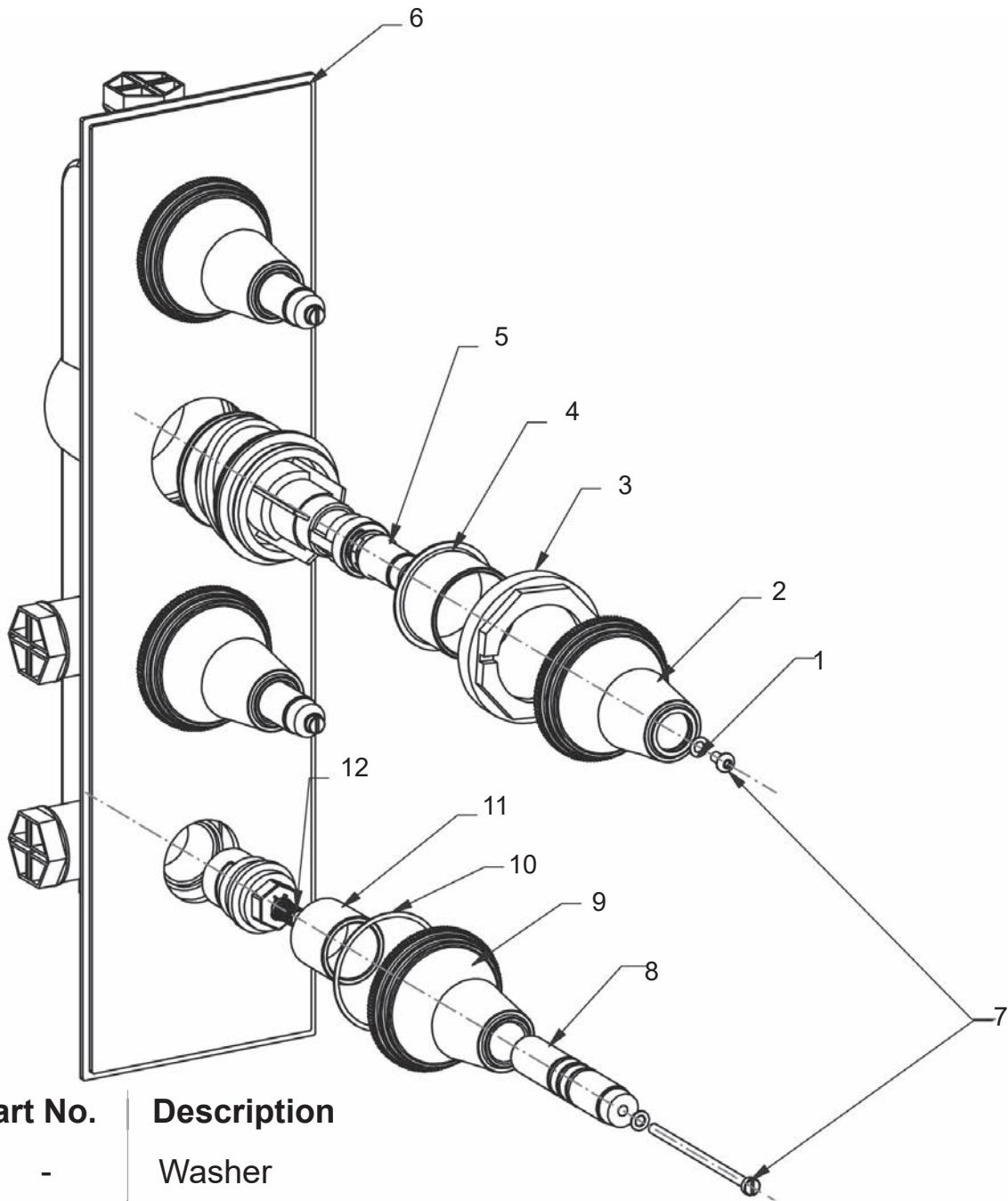

Item	Part No.	Description
1	-	Washer
2	-	Thermo Body
3	-	Swadling Valve
4	-	Thermo Threaded Shank
5	-	Thermostatic Cartridge
6	-	Shower Plate
7	-	Cheese Head Screw
8	-	Volume Spindle
9	-	Volume Body
10	-	O-Ring
11	-	Threaded Shank
12	-	CD Valve

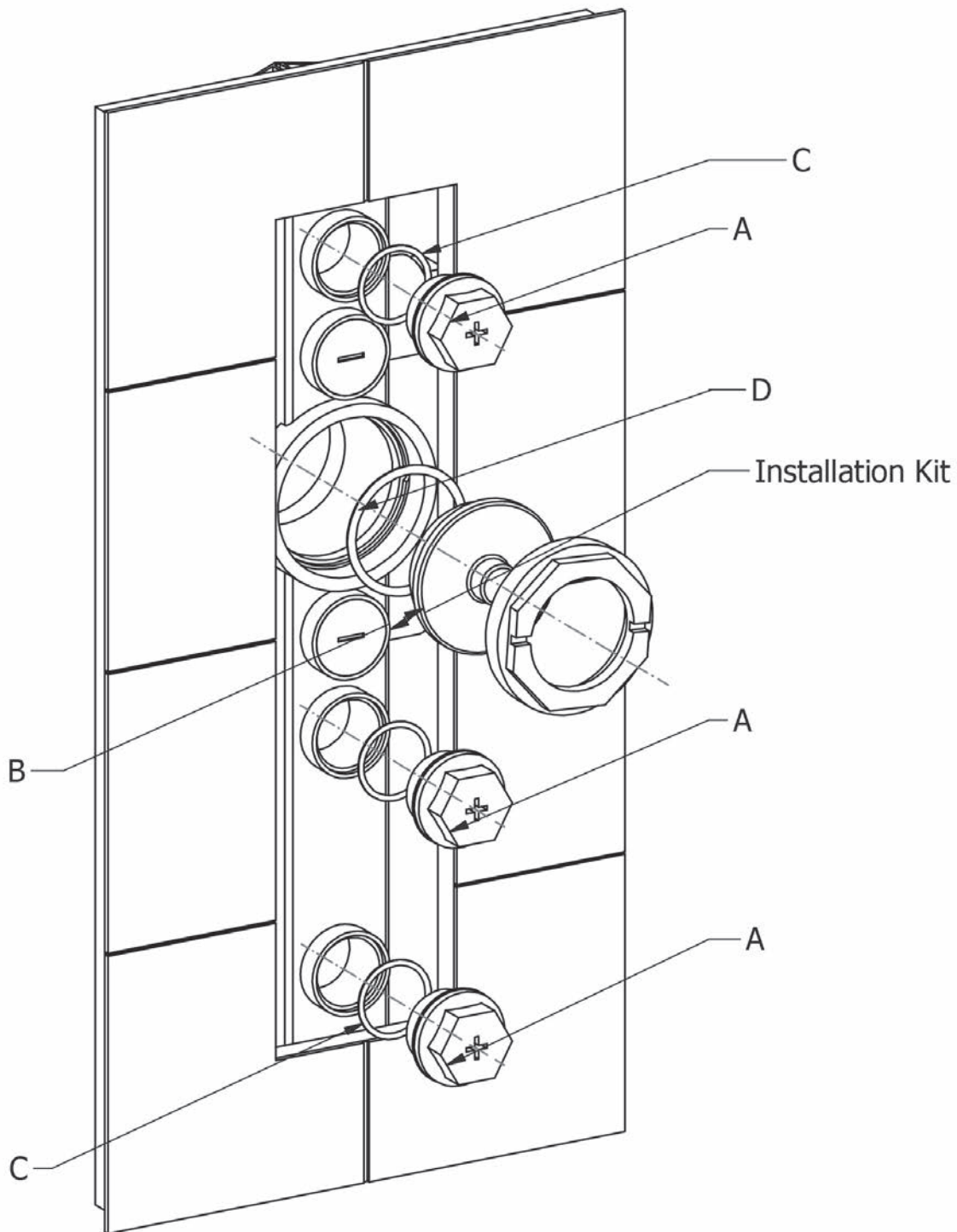

1. Ensure the installation kit VCS606-IS (NOT SUPPLIED) has been installed in accordance with installation instructions supplied with the kit.
2. Once the system has been flushed, remove the blanking caps (A & B) and o-rings (C & D). Ensure both hot and cold supplies to the installation kit have been isolated.

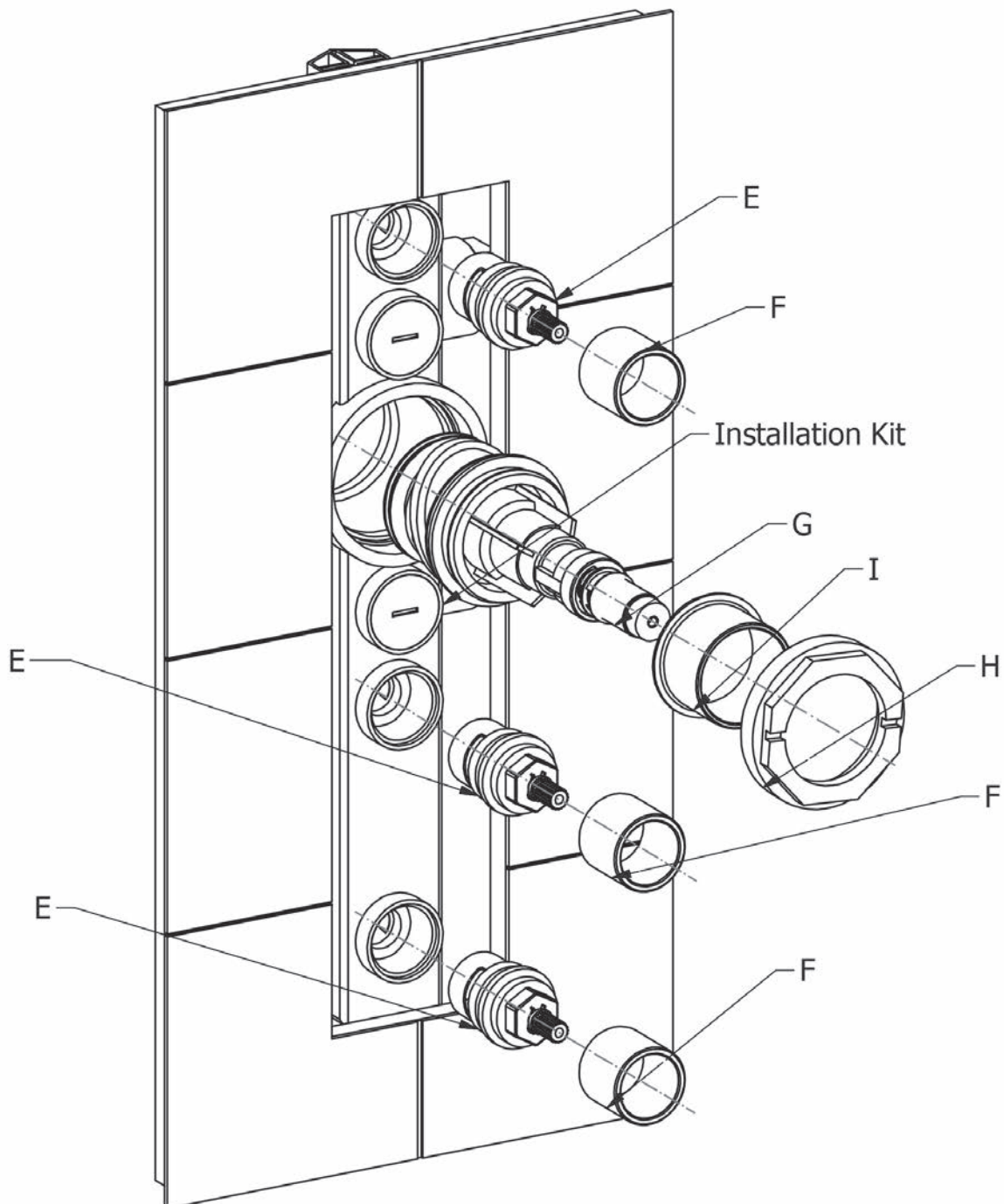

3. Assemble volume cartridges (E) to the installation kit.
4. Screw threaded shanks (F) onto the volume cartridges (E)
5. Unscrew threaded collar (I) from thermo body (L).
6. Insert thermostatic cartridge (G) into the installation kit, place threaded collar (I) over the thermostatic cartridge (G). Lock in position using nut (H), ensuring the threaded collar (I) is captivated.
7. Secure the spindle in place by accessing the concealed screw inside thermo spindle assembly (G) using Allen key (P).

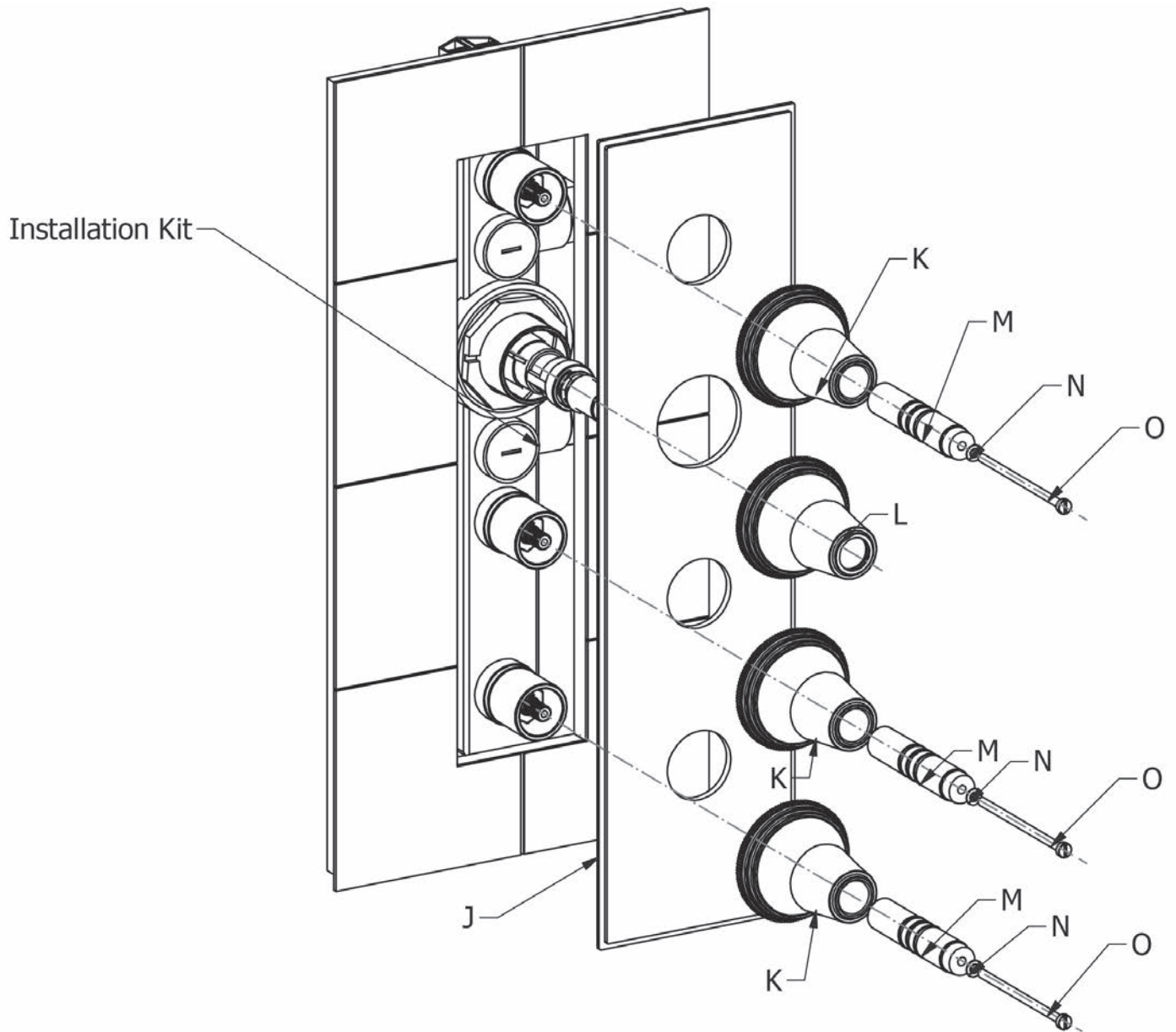

8. Assemble trim plate (J) to the finished surface using a suitable sealant.
9. Screw volume bodies (K) and thermo body (L) onto the installation kit.
10. Assemble volume spindle (M) through the volume body (K) and secure with washer (N) and screw (O).

Claybrook.

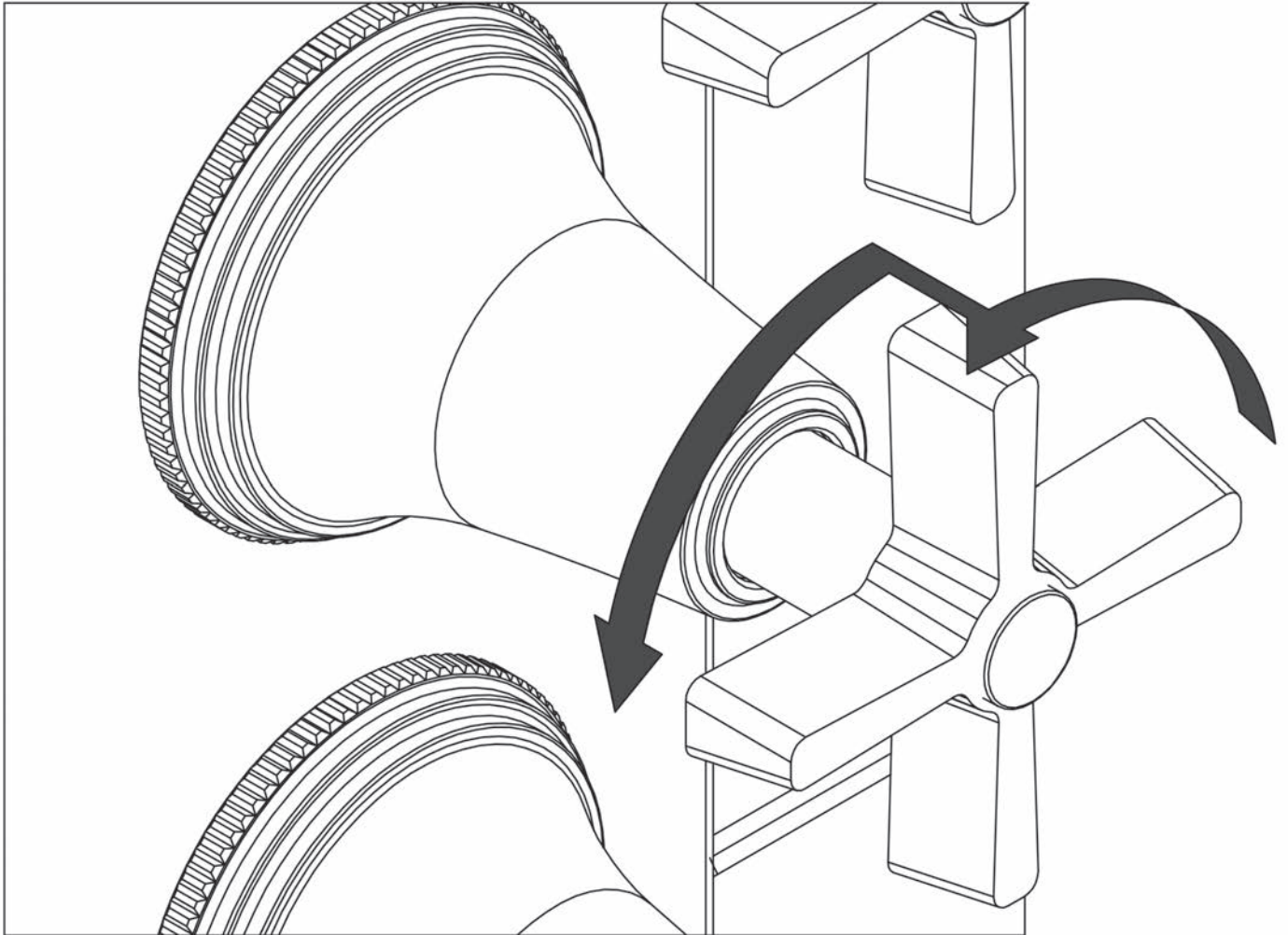

- This product has a pre-set maximum temperature of 41°C - 43°C (106°F - 109°F)
- An additional temperature increase is available by pressing in the sprung loaded cross top as shown at the maximum setting.
- The unit automatically clicks back into pre-override when rotated back towards cold.
- For further temperature increases, please see “Adjusting The Temperature”



Claybrook.

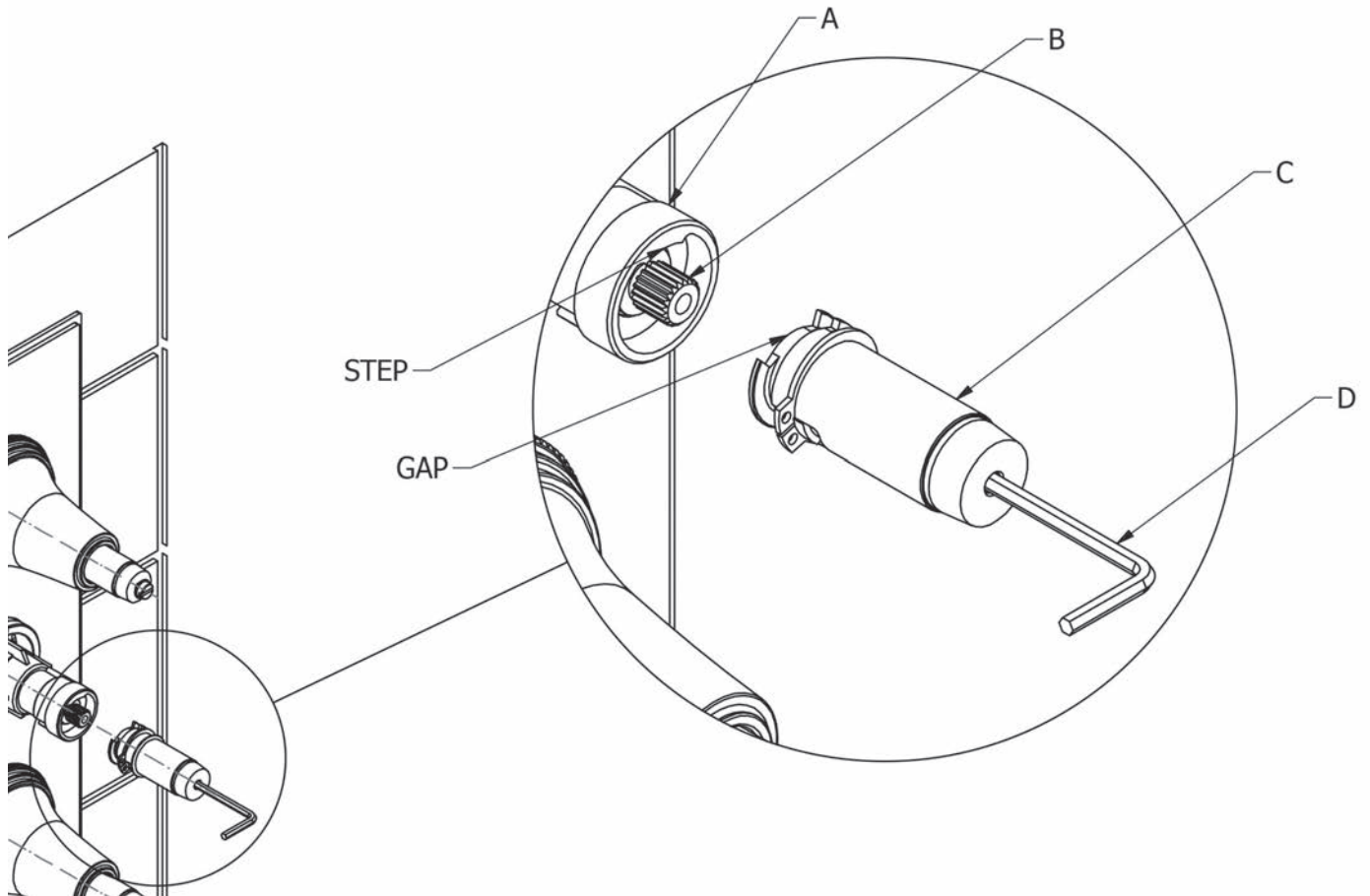

1. Remove thermo body (O).
2. Remove spindle assembly (C) by accessing the concealed screw using Allen key (D).

Note: To remove the spindle assembly (C), the gap in the spindle assembly (C) must be in line with the step on the temperature collar (A).

3. Rotate the spindle anti-clockwise to make the water hotter, and clockwise for colder.
4. Reassemble the spindle assembly (C).



Claybrook.

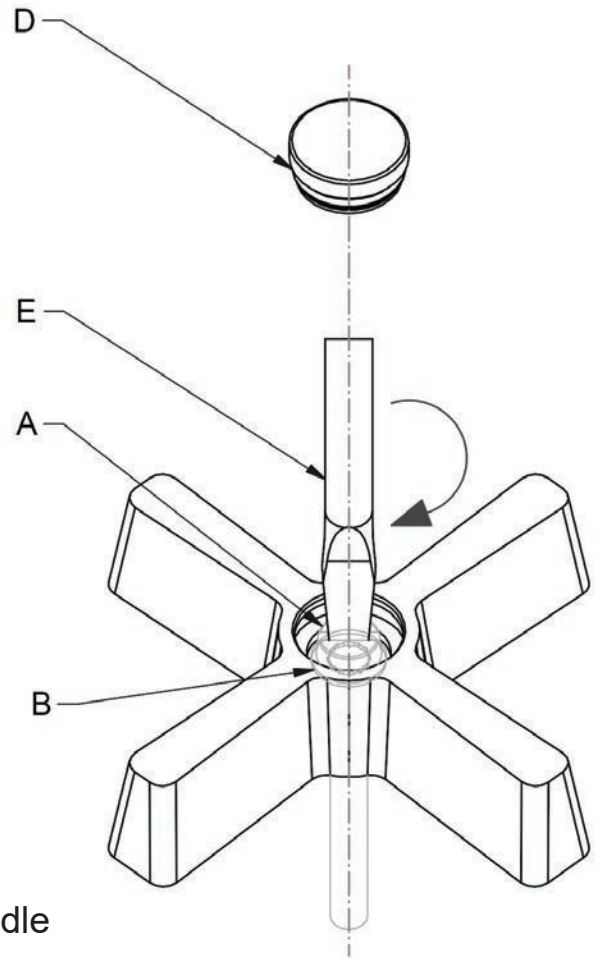
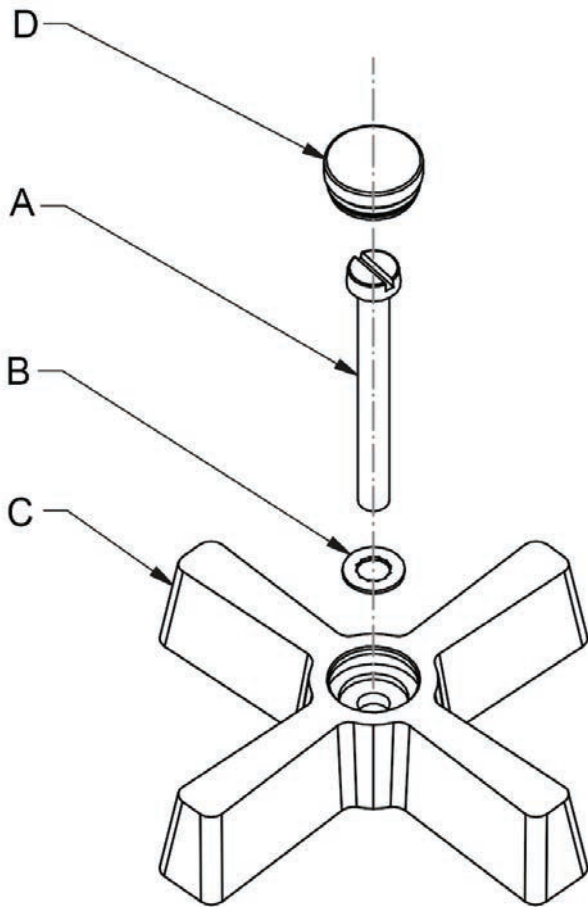

1. Remove screw (A) and washer (B) from spindle
2. Position cross top (C) to tap body and assemble anti-rotational washer (B) followed by screw (A).

Note: It is imperative that the anti-rotational washer is installed

3. Levers are also available (Assembly method is identical). Position lever at is preferred angle.
4. Using a flat edge screwdriver (E), tighten the screw (A) down against the anti-rotational washer (B) to its fullest extent.
5. Insert the indice (D) to complete assembly.



Claybrook.

IMPORTANT NOTES

1. Installation should be carried out by a competent engineer, in accordance with water regulations.
2. Before installation, ensure supply pipes are flushed clean. Debris or loose particles will affect the efficiency of the ceramic disc cartridge.
3. For mixer taps, it is recommended that hot & cold pressures are equally balanced.
4. To help maintain the high quality finish, please clean with a soft damp cloth. Do not use abrasive polish or cleaners. Stains may be removed using undiluted washing up liquid.
5. Ceramic cartridges in hard water areas. To prolong the lifespan and reduce servicing periods of your tap we recommend that a suitable water softener be fitted. Consult your installer/designer for details.
6. Please note that as with all tap and shower ware it will be necessary from time to time for the products to be serviced, this should be carried out by a qualified Plumbing Engineer.

**Claybrook
123 Curtain Road
Shoreditch
London
EC2A 3BX**

Tel: 020 7052 1555

8-40390-T-CS